



T&S BRASS AND BRONZE WORKS, INC.

2 Saddleback Cove / P.O. Box 1088
Travelers Rest, SC 29690



REG. #A2601
ISO #9001

Model No.

B-0220-LN

Item No.

Travelers Rest, SC: 800-476-4103 • Simi Valley, CA: 800-423-0150 • Fax: 864-834-3518 • www.tsbrass.com

ITEM NO.	SALES NO.	DESCRIPTION
1	005959-40	Spindle Asm. Eterna "Cold"
2	005960-40	Spindle Asm, Eterna "Hot"
3	001660-45	Blue Index-CW
4	001661-45	Red Index-HW
5	000922-45	Lever Handle Screw
6	001638-45	Lever Handle
7	001019-45	Coupling Nut Washer
8	00AA	Flange Assembly

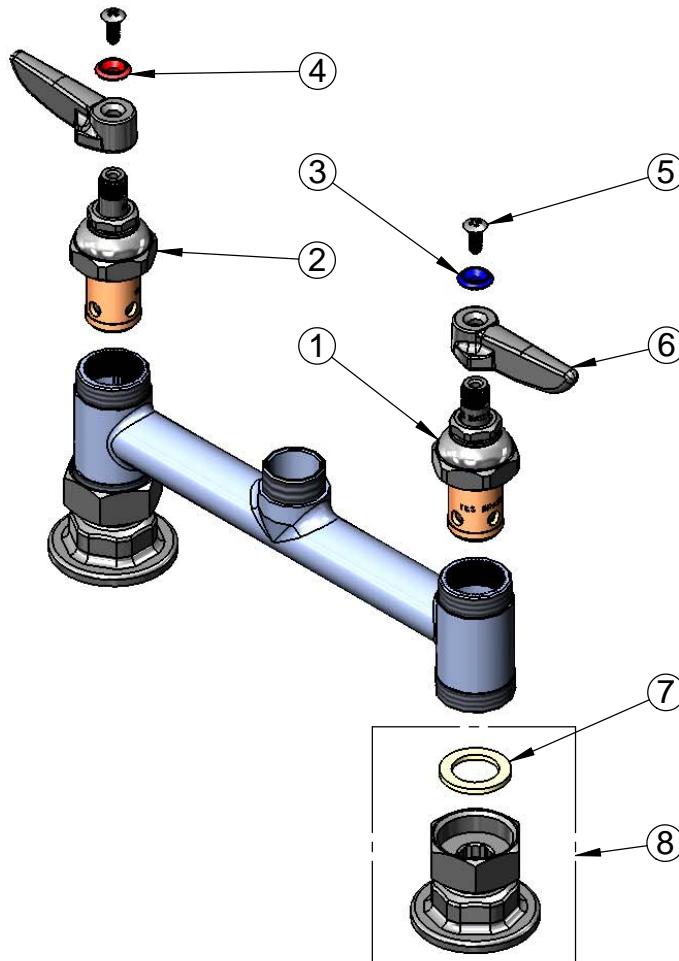

Product Specifications:
8" c/c Base Mixing Faucet (Deck Mount) w/ Eterna Cartridges
& Lever Handles (Less Nozzle)

Drawn

DHL

Checked

JRM

Approved

JHB

Scale:

NTS

Date:

03/22/11