

No.	Name	Qty.	Material	No.	Name	Qty.	Material
1.	Beans hopper lid	1	PP	39.	Powder outlet housing	1	ABS
2.	Beans hopper ring	1	ABS	40.	Safety cover	1	ABS
3.	Beans hopper	1	ABS	41.	Dispenser window	1	ABS
4.	Beanshopper door	1	ABS	42.	Dispenser housing	1	SUS304
5.	Dial	1	Zink	43.	Adjuster stopper	1	MSX10
6.	Hopper fixing Screw	1	MAX10	44.	Portions adjuster	1	Al alloy
7.	Top holder	1	Al alloy	45.	Wiper	2	Steel
8.	Grindstone	2	HSS	46.	Dispenser screw set	4	SUS304
9.	O ring	1	Rubber	47.	Tamper	1	ABS
10.	Helical Spring	1	1065	48.	Disp. top revolver	1	Al alloy
11.	Dial stopper SCREW	1	MAX16	49.	Disp. revolver cover	1	SUS304
12.	Dial Spring	3	1065	50.	Dispenser revolver	1	Al alloy
13.	Grindstone Screw	6	MAX10	51.	Dispenser spring	1	1070
14.	Bottom holder	1	Al alloy	52.	Dispenser revolver Screw	2	M2, 5x12
15.	Dust cover Screw	3	MAX8	53.	Dispenser body fixing Screw	2	M5x40
16.	Shaft Dust cover	1	SUS304	54.	Disp. bottom revolver	1	Al alloy
17.	Motor bearing	2		55.	Dispenser washer	1	PTFE
18.	Body	1	Al alloy	56.	Disp. bottom body	1	Al alloy
19.	Motor	1		57.	Helical spring	1	1065
20.	Back flange	1	Al alloy	58.	Actuator	1	Nylon
21.	Capacitor	1		59.	Dispenser main shaft	1	SUS
22.	Capacitor holder set	1		60.	lock spring	2	1070
23.	Leg set	5		61.	Tongue	1	Nylon
24.	Bottom cover	1	ABS	62.	Tongue washer	1	Steel
25.	Flange Screw	4	M5x16	63.	Dispenser bottom cover	1	Al alloy
26.	Grounding screw	1	MAX10	64.	Tongue spring	1	1070
27.	Bottom tray	1	ABS	65.	Tongue Spring pin	1	1070
28.	Bsp. handle holder	1	Zn alloy	66.	Handle complete	1	ABS
29.	Disp holder Screw	2	MAX10	67.	Disp. bottom cover screw	2	M5x16
30.	Knob	1	ABS	68.	Handle Main Spring	1	1065
31.	Cover Screw	2	MAX18				
32.	Main switch cover	1	Al alloy				
33.	Switch washer	1	PP				
34.	Main switch	1					
35.	Signal Lamp set	1					
36.	Dispenser lid	1	PP				
37.	Cover	1	ABS				
38.	Screw	2	MAX10				

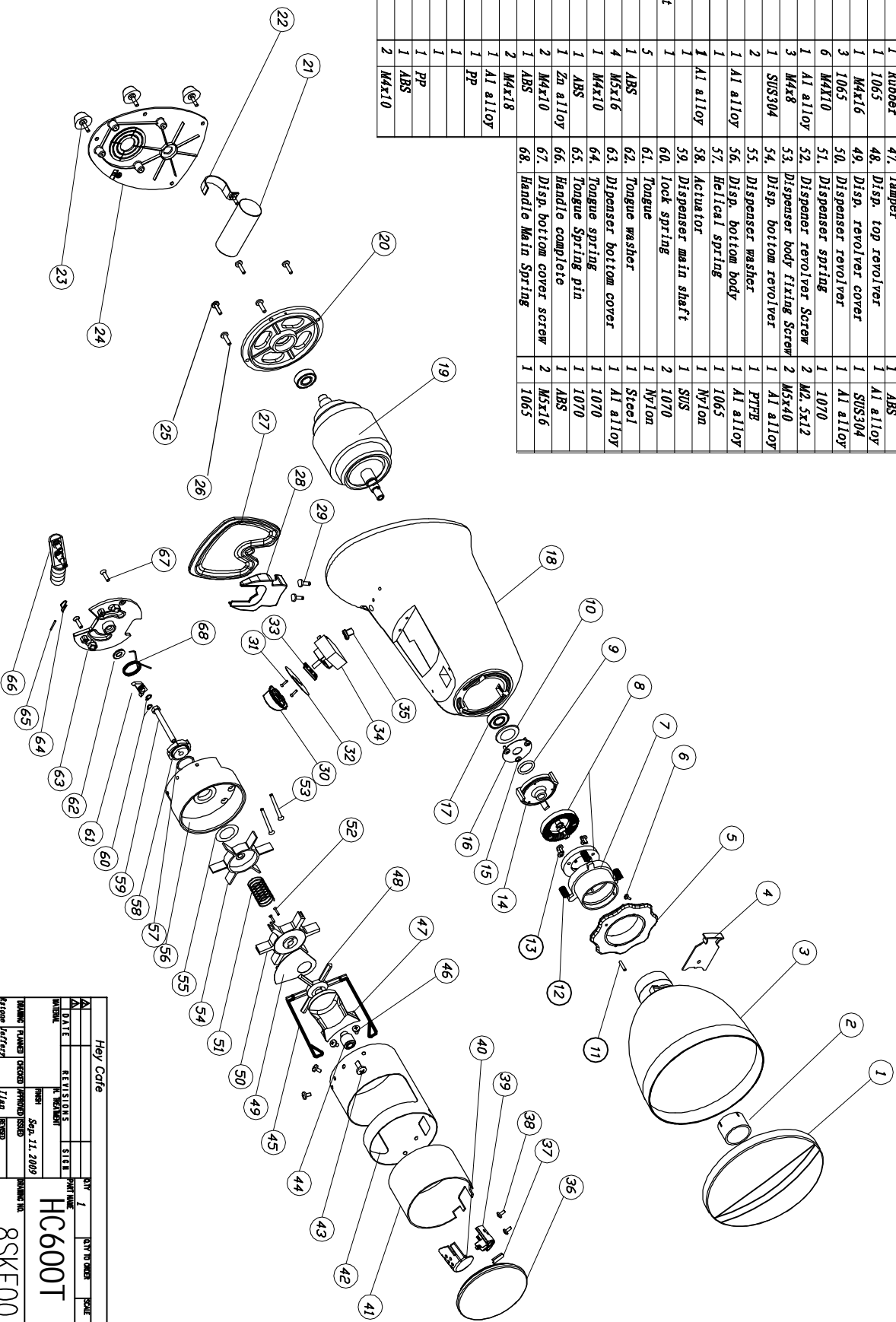

Hey Cafe				REV 1	QTY TO ORDER	SCALE
A	DATE	REVISION	BY	DATE	BY	DATE
DRAWING			PART NAME			HC600T
DRAWING PLANNED (DESIGN)			APPROVED (DESIGN)			8SKF00.
DESIGN (OFFICE)			DRAWING NO.			