



GLO-RAY[®]

***Designer Heated
Display Cases***

GRCD Series

<i>GRCD-1P</i>	<i>GRCD-2P</i>	<i>GRCD-3P</i>
<i>GRCD-1PD</i>	<i>GRCD-2PD</i>	<i>GRCD-3PD</i>
<i>GRCDH-1P</i>	<i>GRCDH-2P</i>	<i>GRCDH-3P</i>
<i>GRCDH-1PD</i>	<i>GRCDH-2PD</i>	<i>GRCDH-3PD</i>

**REPLACEMENT
PARTS LIST**

**HATCO GLO-RAY®
DESIGNER HEATED DISPLAY CASES
GRCD SERIES**

Model Designation

GRCD-XPD

G= Glo
R= Ray
C= Curved
D= Display
X= Full Size Pan Capacity
on Bottom Shelf
P= Pan
D= Dual Shelf

**GRCD-1P & GRCDH-1P
MODELS ONLY**

8A, 8B

8A, 8B

9A, 9B

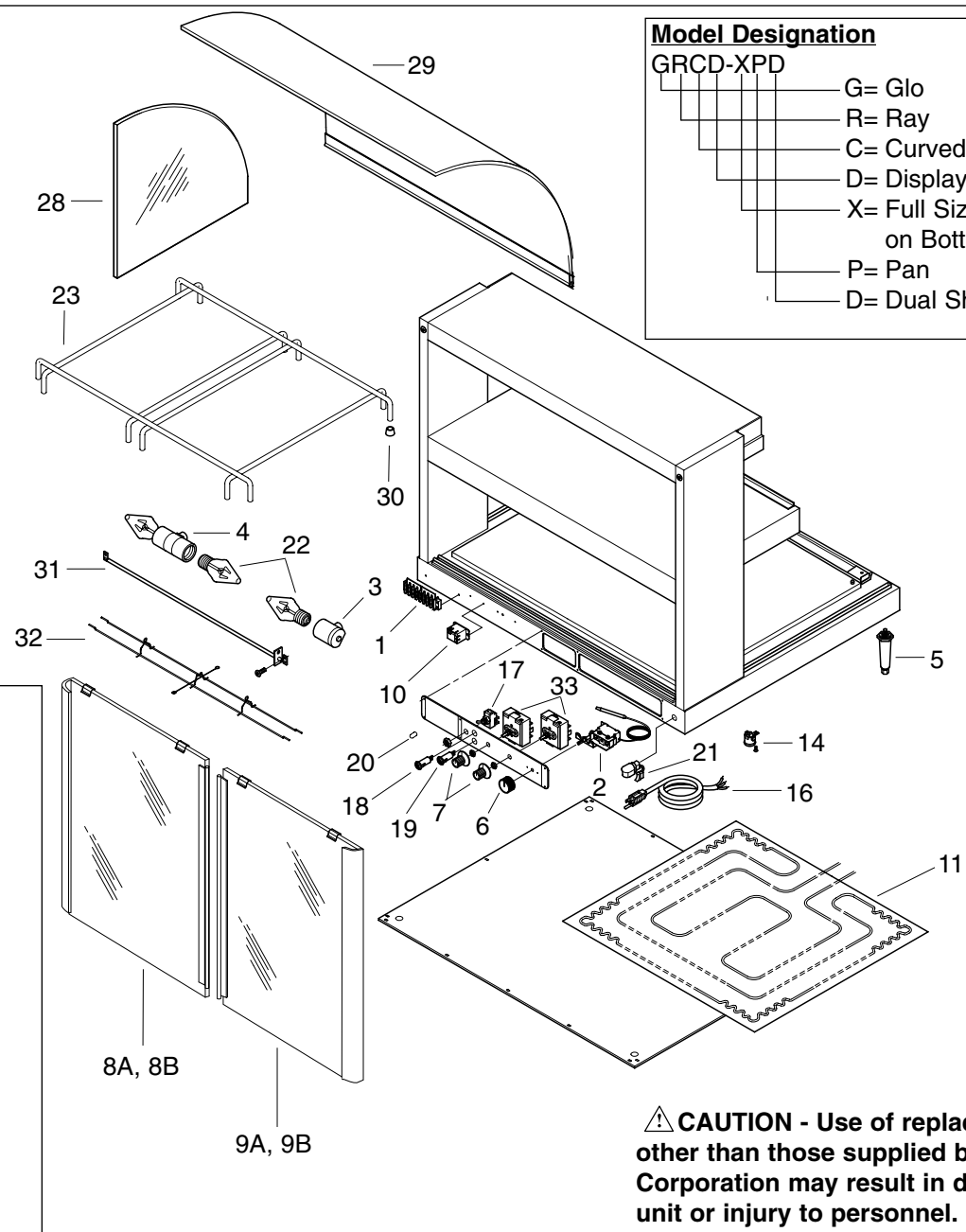

⚠ CAUTION - Use of replacement parts other than those supplied by Hatco Corporation may result in damage to the unit or injury to personnel.

**HATCO GLO-RAY®
DESIGNER HEATED DISPLAY CASES
GRCDH SERIES**

Model Designation

GRCDH-XPD

G= Glo
R= Ray
C= Curved
D= Display
H= Humidified
X= Full Size Pan Capacity on
Bottom Shelf
P= Pan
D= Dual Shelf

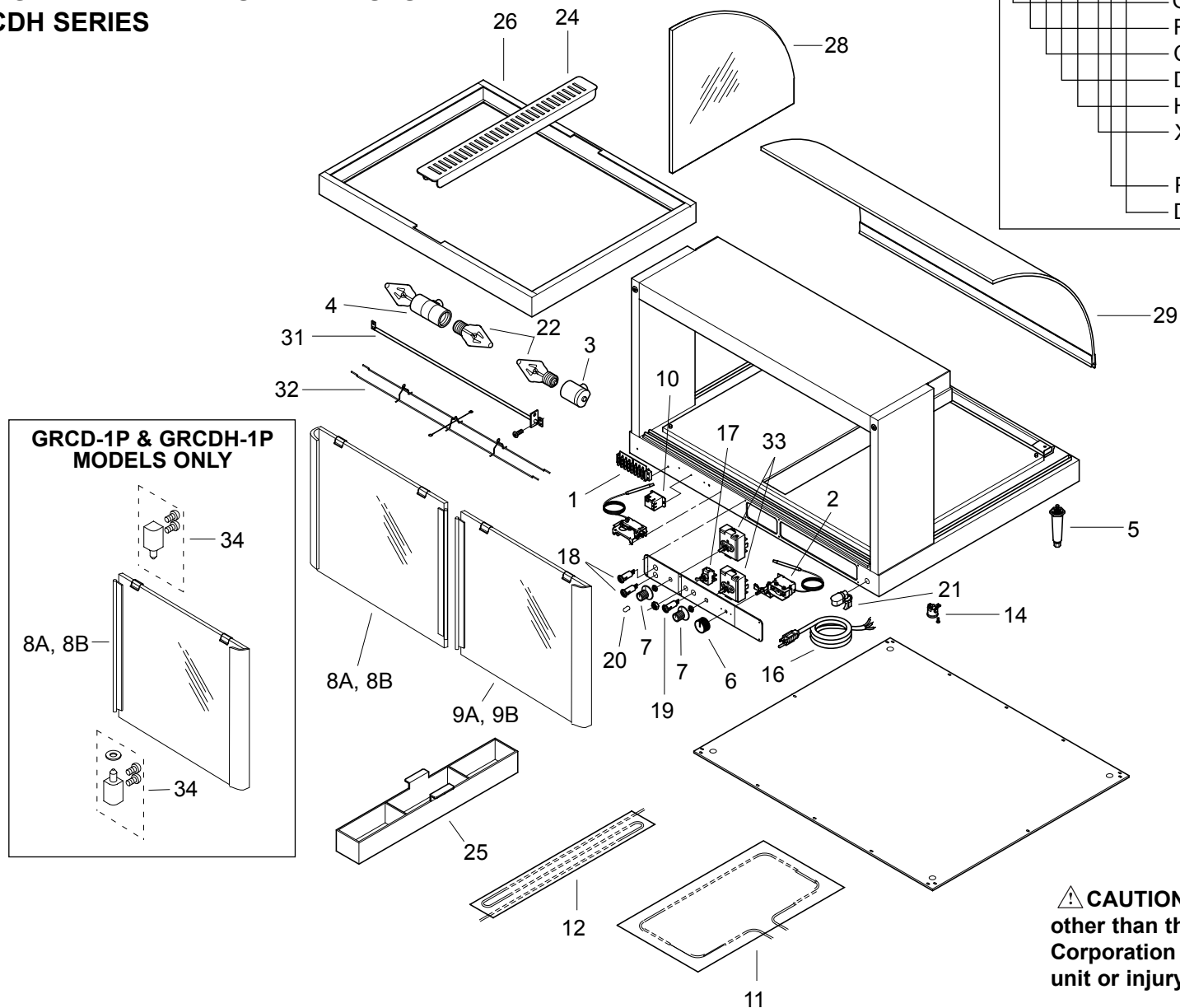

PARTS COMMON TO ALL GRCD/GRCDH MODELS

ITEM	DESCRIPTION	PART NO.	QTY.	ITEM	DESCRIPTION	PART NO.	QTY.
1	Terminal Block, 8-Pole	02.15.012.00	1	5	Legs	05.30.007.00	4
2	Thermostat, Base	02.16.030.00	1	6	Knob, Thermostat	05.30.018.00	1
3	Light Socket, Single	02.30.044.00	1-2	7	Knob, Infinite Switch	05.30.043.00	1-3
4	Light Socket, Dual	02.30.045.00	1-2				

PARTS SPECIFIC TO MODEL GRCD-1P

ITEM	DESCRIPTION	100V	120V	120V CSA	220V	240V	220-230V CE	230-240V CE
8A	Glass Door	---	R04.40.129.00	R04.40.129.00	R04.40.129.00	R04.40.129.00	R04.40.129.00	R04.40.129.00
8B	Glass Door, Mirror	---	R04.40.138.00	R04.40.138.00	R04.40.138.00	R04.40.138.00	R04.40.138.00	R04.40.138.00
9A	Glass Door	---	---	---	---	---	---	---
9B	Glass Door, Mirror	---	---	---	---	---	---	---
10	Relay	---	---	---	---	---	---	---
11	Heating Element, Base	---	02.05.293.00	02.05.293.00	02.05.294.00	02.05.294.00	02.05.294.00	02.05.294.00
12	Heating Element, Water	---	---	---	---	---	---	---
13	Terminal Block, 3-Pole*	---	---	---	---	---	R02.15.030.00	R02.15.030.00
14	High Limit, Automatic	---	---	---	---	---	---	---
15	High Limit, Manual*	---	---	---	---	---	---	---
16	Power Cord with Plug	---	R02.18.030.00	R02.18.030.00	02.18.077.00	02.18.066.00	02.18.077.00	02.18.066.00
17	On/Off Switch	---	R02.19.016.00	R02.19.016.00	R02.19.008A.00	R02.19.008A.00	R02.19.008A.00	R02.19.008A.00
18	Indicator Light, Red	---	02.19.154.00	02.19.154.00	02.19.151.00	02.19.151.00	---	---
	Indicator Light, Yellow	---	---	---	---	---	---	---
19	Indicator Light, Green	---	---	---	---	---	02.19.150.00	02.19.150.00
20	Rubber Boot, Toggle Switch	---	---	---	---	---	02.20.040.00	02.20.040.00
21	Strain Relief	---	02.20.206.00	02.20.206.00	02.20.212.00	02.20.212.00	02.20.212.00	02.20.212.00
22	Light Bulb	---	02.30.043.00	02.30.043.00	02.30.058.00	02.30.058.00	02.30.058.00	02.30.058.00
23	Pan Rail	---	04.22.364.00	04.22.364.00	04.22.364.00	04.22.364.00	04.22.364.00	04.22.364.00
24	Pan Divider (optional)	---	04.22.400.00	04.22.400.00	04.22.400.00	04.22.400.00	04.22.400.00	04.22.400.00
25	Water Trough	---	---	---	---	---	---	---
26	Pan Enclosure, 2 Pan	---	---	---	---	---	---	---
27	Pan Enclosure, 1 Pan*	---	04.22.357.00	04.22.357.00	04.22.357.00	04.22.357.00	04.22.357.00	04.22.357.00
28	End Glass (Qty. 2)	---	04.40.105.00	04.40.105.00	04.40.105.00	04.40.105.00	04.40.105.00	04.40.105.00
29	Curved Glass, Front	---	R04.40.127.00	R04.40.127.00	R04.40.127.00	R04.40.127.00	R04.40.127.00	R04.40.127.00
30	Rubber Foot, Pan Rail (Qty. 8)	---	05.06.039.00	05.06.039.00	05.06.039.00	05.06.039.00	05.06.039.00	05.06.039.00
31	Heating Element, Upper	---	R02.08.258.00	R02.08.258.00	R02.08.038.00	R02.08.261.00	R02.08.038.00	R02.08.261.00
32	Wire Guard	---	04.08.113.00	04.08.113.00	04.08.113.00	04.08.113.00	04.08.113.00	04.08.113.00
33	Infinite Control Switch	---	R02.19.018.00	R02.19.018.00	R02.19.019.00	R02.19.019.00	R02.19.019.00	R02.19.019.00
34	Hinge Kit	---	R00.01.0115.00	R00.01.0115.00	R00.01.0115.00	R00.01.0115.00	R00.01.0115.00	R00.01.0115.00
	Electrical Drawing	---	HS2-4741	HS2-4741	HS2-4742	HS2-4743	HS2-5149	HS2-5150

Shaded area reflects export models only.

* Not Shown

PARTS SPECIFIC TO MODEL GRCD-1PD

ITEM	DESCRIPTION	100V	120V	120V CSA	220V	240V	220-230V CE	230-240V CE
8A	Glass Door	---	R04.40.130.00	R04.40.130.00	R04.40.130.00	R04.40.130.00	R04.40.130.00	R04.40.130.00
8B	Glass Door, Mirror	---	R04.40.139.00	R04.40.139.00	R04.40.139.00	R04.40.139.00	R04.40.139.00	R04.40.139.00
9A	Glass Door	---	---	---	---	---	---	---
9B	Glass Door, Mirror	---	---	---	---	---	---	---
10	Relay	---	---	---	---	---	---	---
11	Heating Element, Base	---	02.05.293.00	02.05.293.00	02.05.294.00	02.05.294.00	02.05.294.00	02.05.294.00
12	Heating Element, Water	---	---	---	---	---	---	---
13	Terminal Block, 3-Pole*	---	---	---	---	---	R02.15.030.00	R02.15.030.00
14	High Limit, Automatic	---	---	---	---	---	---	---
15	High Limit, Manual*	---	---	---	---	---	---	---
16	Power Cord with Plug	---	R02.18.030.00	R02.18.030.00	02.18.077.00	02.18.066.00	02.18.077.00	02.18.066.00
17	On/Off Switch	---	R02.19.016.00	R02.19.016.00	R02.19.008A.00	R02.19.008A.00	R02.19.008A.00	R02.19.008A.00
18	Indicator Light, Red	---	02.19.154.00	02.19.154.00	02.19.151.00	02.19.151.00	---	---
	Indicator Light, Yellow	---	---	---	---	---	---	---
19	Indicator Light, Green	---	---	---	---	---	02.19.150.00	02.19.150.00
20	Rubber Boot, Toggle Switch	---	---	---	---	---	02.20.040.00	02.20.040.00
21	Strain Relief	---	02.20.206.00	02.20.206.00	02.20.212.00	02.20.212.00	02.20.212.00	02.20.212.00
22	Light Bulb	---	02.30.043.00	02.30.043.00	02.30.058.00	02.30.058.00	02.30.058.00	02.30.058.00
23	Pan Rail	---	04.22.364.00	04.22.364.00	04.22.364.00	04.22.364.00	04.22.364.00	04.22.364.00
24	Pan Divider (optional)	---	04.22.400.00	04.22.400.00	04.22.400.00	04.22.400.00	04.22.400.00	04.22.400.00
25	Water Trough	---	---	---	---	---	---	---
26	Pan Enclosure, 2 Pan	---	---	---	---	---	---	---
27	Pan Enclosure, 1 Pan*	---	04.22.357.00	04.22.357.00	04.22.357.00	04.22.357.00	04.22.357.00	04.22.357.00
28	End Glass (Qty. 2)	---	04.40.091.00	04.40.091.00	04.40.091.00	04.40.091.00	04.40.091.00	04.40.091.00
29	Curved Glass, Front	---	R04.40.128.00	R04.40.128.00	R04.40.128.00	R04.40.128.00	R04.40.128.00	R04.40.128.00
30	Rubber Foot, Pan Rail (Qty. 8)	---	05.06.039.00	05.06.039.00	05.06.039.00	05.06.039.00	05.06.039.00	05.06.039.00
31	Heating Element, Upper (Qty. 3)	---	R02.08.258.00	R02.08.258.00	R02.08.038.00	R02.08.261.00	R02.08.038.00	R02.08.261.00
32	Wire Guard (Qty. 2)	---	04.08.113.00	04.08.113.00	04.08.113.00	04.08.113.00	04.08.113.00	04.08.113.00
33	Infinite Control Switch (Qty. 2)	---	R02.19.018.00	R02.19.018.00	R02.19.019.00	R02.19.019.00	R02.19.019.00	R02.19.019.00
34	Hinge Kit	---	R00.01.0115.00	R00.01.0115.00	R00.01.0115.00	R00.01.0115.00	R00.01.0115.00	R00.01.0115.00
	Electrical Drawing	---	HS2-4748	HS2-4748	HS2-4749	HS2-4750	HS2-5153	HS2-5154

Shaded area reflects export models only.

* Not Shown

PARTS SPECIFIC TO MODEL GRCDH-1P

ITEM	DESCRIPTION	100V	120V	120V CSA	220V	240V	220-230V CE	230-240V CE
8A	Glass Door	---	R04.40.129.00	R04.40.129.00	R04.40.129.00	R04.40.129.00	R04.40.129.00	R04.40.129.00
8B	Glass Door, Mirror	---	R04.40.138.00	R04.40.138.00	R04.40.138.00	R04.40.138.00	R04.40.138.00	R04.40.138.00
9A	Glass Door	---	---	---	---	---	---	---
9B	Glass Door, Mirror	---	---	---	---	---	---	---
10	Relay	---	02.01.088.00	02.01.088.00	02.01.180.00	02.01.105.00	02.01.180.00	02.01.105.00
11	Heating Element, Base	---	02.05.293.00	02.05.293.00	02.05.294.00	02.05.294.00	02.05.294.00	02.05.294.00
12	Heating Element, Water	---	02.05.295.00	02.05.295.00	02.05.296.00	02.05.296.00	02.05.296.00	02.05.296.00
13	Terminal Block, 3-Pole*	---	---	---	---	---	R02.15.030.00	R02.15.030.00
14	High Limit, Automatic	---	R02.16.036.00	R02.16.036.00	R02.16.036.00	R02.16.036.00	R02.16.036.00	R02.16.036.00
15	High Limit, Manual*	---	02.16.071.00	02.16.071.00	02.16.071.00	02.16.071.00	02.16.071.00	02.16.071.00
16	Power Cord with Plug	---	R02.18.030.00	R02.18.030.00	02.18.077.00	02.18.066.00	02.18.077.00	02.18.066.00
17	On/Off Switch	---	R02.19.016.00	R02.19.016.00	R02.19.008A.00	R02.19.008A.00	R02.19.008A.00	R02.19.008A.00
18	Indicator Light, Red	---	02.19.154.00	02.19.154.00	02.19.151.00	02.19.151.00	---	---
	Indicator Light, Yellow	---	---	---	---	---	02.19.152.00	02.19.152.00
19	Indicator Light, Green	---	02.19.155.00	02.19.155.00	02.19.150.00	02.19.150.00	02.19.150.00	02.19.150.00
20	Rubber Boot, Toggle Switch	---	---	---	---	---	02.20.040.00	02.20.040.00
21	Strain Relief	---	02.20.206.00	02.20.206.00	02.20.212.00	02.20.212.00	02.20.212.00	02.20.212.00
22	Light Bulb	---	02.30.043.00	02.30.043.00	02.30.058.00	02.30.058.00	02.30.058.00	02.30.058.00
23	Pan Rail	---	---	---	---	---	---	---
24	Pan Divider (optional)	---	04.22.400.00	04.22.400.00	04.22.400.00	04.22.400.00	04.22.400.00	04.22.400.00
25	Water Trough	---	04.22.403.00	04.22.403.00	04.22.403.00	04.22.403.00	04.22.403.00	04.22.403.00
26	Pan Enclosure, 2 Pan	---	---	---	---	---	---	---
27	Pan Enclosure, 1 Pan*	---	04.22.357.00	04.22.357.00	04.22.357.00	04.22.357.00	04.22.357.00	04.22.357.00
28	End Glass (Qty. 2)	---	04.40.105.00	04.40.105.00	04.40.105.00	04.40.105.00	04.40.105.00	04.40.105.00
29	Curved Glass, Front	---	R04.40.127.00	R04.40.127.00	R04.40.127.00	R04.40.127.00	R04.40.127.00	R04.40.127.00
30	Rubber Foot, Pan Rail	---	---	---	---	---	---	---
31	Heating Element, Upper	---	R02.08.258.00	R02.08.258.00	R02.08.038.00	R02.08.261.00	R02.08.038.00	R02.08.261.00
32	Wire Guard	---	04.08.113.00	04.08.113.00	04.08.113.00	04.08.113.00	04.08.113.00	04.08.113.00
33	Infinite Control Switch (Qty. 2)	---	R02.19.018.00	R02.19.018.00	R02.19.019.00	R02.19.019.00	R02.19.019.00	R02.19.019.00
34	Hinge Kit	---	R00.01.0115.00	R00.01.0115.00	R00.01.0115.00	R00.01.0115.00	R00.01.0115.00	R00.01.0115.00
	Electrical Drawing	---	HS2-4744	HS2-4744	HS2-4745	HS2-4746	HS2-5151	HS2-5152

Shaded area reflects export models only.

* Not Shown

PARTS SPECIFIC TO MODEL GRCDH-1PD								
ITEM	DESCRIPTION	100V	120V	120V CSA	220V	240V	220-230V CE	230-240V CE
8A	Glass Door	---	R04.40.130.00	R04.40.130.00	R04.40.130.00	R04.40.130.00	R04.40.130.00	R04.40.130.00
8B	Glass Door, Mirror	---	R04.40.139.00	R04.40.139.00	R04.40.139.00	R04.40.139.00	R04.40.139.00	R04.40.139.00
9A	Glass Door	---	---	---	---	---	---	---
9B	Glass Door, Mirror	---	---	---	---	---	---	---
10	Relay	---	02.01.088.00	02.01.088.00	02.01.180.00	02.01.105.00	02.01.180.00	02.01.105.00
11	Heating Element, Base (Qty. 2)	---	02.05.293.00	02.05.293.00	02.05.294.00	02.05.294.00	02.05.294.00	02.05.294.00
12	Heating Element, Water	---	02.05.295.00	02.05.295.00	02.05.296.00	02.05.296.00	02.05.296.00	02.05.296.00
13	Terminal Block, 3-Pole*	---	---	---	---	---	R02.15.030.00	R02.15.030.00
14	High Limit, Automatic	---	R02.16.036.00	R02.16.036.00	R02.16.036.00	R02.16.036.00	R02.16.036.00	R02.16.036.00
15	High Limit, Manual*	---	02.16.071.00	02.16.071.00	02.16.071.00	02.16.071.00	02.16.071.00	02.16.071.00
16	Power Cord with Plug	---	R02.18.030.00	R02.18.030.00	02.18.077.00	02.18.066.00	02.18.077.00	02.18.066.00
17	On/Off Switch	---	R02.19.016.00	R02.19.016.00	R02.19.008A.00	R02.19.008A.00	R02.19.008A.00	R02.19.008A.00
18	Indicator Light, Red	---	02.19.154.00	02.19.154.00	02.19.151.00	02.19.151.00	---	---
	Indicator Light, Yellow	---	---	---	---	---	02.19.152.00	02.19.152.00
19	Indicator Light, Green	---	02.19.155.00	02.19.155.00	02.19.150.00	02.19.150.00	02.19.150.00	02.19.150.00
20	Rubber Boot, Toggle Switch	---	---	---	---	---	02.20.040.00	02.20.040.00
21	Strain Relief	---	02.20.206.00	02.20.206.00	02.20.212.00	02.20.212.00	02.20.212.00	02.20.212.00
22	Light Bulb	---	02.30.043.00	02.30.043.00	02.30.058.00	02.30.058.00	02.30.058.00	02.30.058.00
23	Pan Rail	---	---	---	---	---	---	---
24	Pan Divider (optional)	---	04.22.400.00	04.22.400.00	04.22.400.00	04.22.400.00	04.22.400.00	04.22.400.00
25	Water Trough	---	04.22.403.00	04.22.403.00	04.22.403.00	04.22.403.00	04.22.403.00	04.22.403.00
26	Pan Enclosure, 2 Pan	---	---	---	---	---	---	---
27	Pan Enclosure, 1 Pan*	---	04.22.357.00	04.22.357.00	04.22.357.00	04.22.357.00	04.22.357.00	04.22.357.00
28	End Glass (Qty. 2)	---	04.40.091.00	04.40.091.00	04.40.091.00	04.40.091.00	04.40.091.00	04.40.091.00
29	Curved Glass, Front	---	R04.40.128.00	R04.40.128.00	R04.40.128.00	R04.40.128.00	R04.40.128.00	R04.40.128.00
30	Rubber Foot, Pan Rail	---	---	---	---	---	---	---
31	Heating Element, Upper (Qty. 3)	---	R02.08.258.00	R02.08.258.00	R02.08.038.00	R02.08.261.00	R02.08.038.00	R02.08.261.00
32	Wire Guard	---	04.08.113.00	04.08.113.00	04.08.113.00	04.08.113.00	04.08.113.00	04.08.113.00
33	Infinite Control Switch (Qty. 3)	---	R02.19.018.00	R02.19.018.00	R02.19.019.00	R02.19.019.00	R02.19.019.00	R02.19.019.00
34	Hinge Kit	---	R00.01.0115.00	R00.01.0115.00	R00.01.0115.00	R00.01.0115.00	R00.01.0115.00	R00.01.0115.00
	Electrical Drawing	---	HS2-4751	HS2-4751	HS2-4752	HS2-4753	HS2-5155	HS2-5156

Shaded area reflects export models only.

* Not Shown

PARTS SPECIFIC TO MODEL GRCD-2P								
ITEM	DESCRIPTION	100V	120V	120V CSA	220V	240V	220-230V CE	230-240V CE
8A	Glass Door, Inner	---	R00.01.0026.00	R00.01.0026.00	R00.01.0026.00	R00.01.0026.00	R00.01.0026.00	R00.01.0026.00
8B	Glass Door, Inner, Mirror	---	R00.01.0034.00	R00.01.0034.00	R00.01.0034.00	R00.01.0034.00	R00.01.0034.00	R00.01.0034.00
9A	Glass Door, Outer	---	R00.01.0025.00	R00.01.0025.00	R00.01.0025.00	R00.01.0025.00	R00.01.0025.00	R00.01.0025.00
9B	Glass Door, Outer, Mirror	---	R00.01.0033.00	R00.01.0033.00	R00.01.0033.00	R00.01.0033.00	R00.01.0033.00	R00.01.0033.00
10	Relay	---	---	---	---	---	---	---
11	Heating Element, Base (Qty. 2)	---	02.05.293.00	02.05.293.00	02.05.294.00	02.05.294.00	02.05.294.00	02.05.294.00
12	Heating Element, Water	---	---	---	---	---	---	---
13	Terminal Block, 3-Pole*	---	---	---	---	---	02.15.030.00	02.15.030.00
14	High Limit, Automatic	---	---	---	---	---	---	---
15	High Limit, Manual*	---	---	---	---	---	---	---
16	Power Cord with Plug	---	R02.18.030.00	R02.18.030.00	02.18.077.00	02.18.066.00	02.18.077.00	02.18.066.00
17	On/Off Switch	---	02.19.016.00	02.19.016.00	02.19.006.00	02.19.006.00	02.19.008A.00	02.19.008A.00
18	Indicator Light, Red	---	02.19.154.00	02.19.154.00	02.19.151.00	02.19.151.00	---	---
	Indicator Light, Yellow	---	---	---	---	---	---	---
19	Indicator Light, Green	---	---	---	---	---	02.19.150.00	02.19.150.00
20	Rubber Boot, Toggle Switch	---	---	---	---	---	02.20.040.00	02.20.040.00
21	Strain Relief	---	02.20.206.00	02.20.206.00	02.20.212.00	02.20.212.00	02.20.212.00	02.20.212.00
22	Light Bulb (Qty. 3)	---	02.30.043.00	02.30.043.00	02.30.058.00	02.30.058.00	02.30.058.00	02.30.058.00
23	Pan Rail	---	04.22.030.00	04.22.030.00	04.22.030.00	04.22.030.00	04.22.030.00	04.22.030.00
24	Pan Divider (optional)	---	04.22.400.00	04.22.400.00	04.22.400.00	04.22.400.00	04.22.400.00	04.22.400.00
25	Water Trough	---	---	---	---	---	---	---
26	Pan Enclosure, 2 Pan (optional)	---	04.22.406.00	04.22.406.00	04.22.406.00	04.22.406.00	04.22.406.00	04.22.406.00
27	Pan Enclosure, 1 Pan*	---	---	---	---	---	---	---
28	End Glass (Qty. 2)	---	04.40.105.00	04.40.105.00	04.40.105.00	04.40.105.00	04.40.105.00	04.40.105.00
29	Curved Glass, Front	---	04.40.106.00	R04.40.106.00	R04.40.106.00	R04.40.106.00	R04.40.106.00	R04.40.106.00
30	Rubber Foot, Pan Rail (Qty. 12)	---	05.06.039.00	05.06.039.00	05.06.039.00	05.06.039.00	05.06.039.00	05.06.039.00
31	Heating Element, Upper	---	R02.08.202.00	R02.08.202.00	R02.08.250.00	R02.08.251.00	R02.08.250.00	R02.08.251.00
32	Wire Guard	---	04.08.112.00	04.08.112.00	04.08.112.00	04.08.112.00	04.08.112.00	04.08.112.00
33	Infinite Control Switch	---	R02.19.018.00	R02.19.018.00	R02.19.019.00	R02.19.019.00	R02.19.019.00	R02.19.019.00
	Electrical Drawing	---	HS2-3538	HS2-3538	HS2-3542	HS2-3542	HS2-4159	HS2-4160

Shaded area reflects export models only.

* Not Shown

PARTS SPECIFIC TO MODEL GRCD-2PD								
ITEM	DESCRIPTION	100V	120V	120V CSA	220V	240V	220-230V CE	230-240V CE
8A	Glass Door, Inner	---	R00.01.0030.00	R00.01.0030.00	R00.01.0030.00	R00.01.0030.00	R00.01.0030.00	R00.01.0030.00
8B	Glass Door, Inner, Mirror	---	R00.01.0038.00	R00.01.0038.00	R00.01.0038.00	R00.01.0038.00	R00.01.0038.00	R00.01.0038.00
9A	Glass Door, Outer	---	R00.01.0029.00	R00.01.0029.00	R00.01.0029.00	R00.01.0029.00	R00.01.0029.00	R00.01.0029.00
9B	Glass Door, Outer, Mirror	---	R00.01.0037.00	R00.01.0037.00	R00.01.0037.00	R00.01.0037.00	R00.01.0037.00	R00.01.0037.00
10	Relay	---	---	---	---	---	---	---
11	Heating Element, Base (Qty. 2)	---	02.05.293.00	02.05.293.00	02.05.294.00	02.05.294.00	02.05.294.00	02.05.294.00
12	Heating Element, Water	---	---	---	---	---	---	---
13	Terminal Block, 3-Pole*	---	---	---	---	---	02.15.030.00	02.15.030.00
14	High Limit, Automatic	---	---	---	---	---	---	---
15	High Limit, Manual*	---	---	---	---	---	---	---
16	Power Cord with Plug	---	R02.18.030.00	R02.18.030.00	02.18.077.00	02.18.068.00	02.18.077.00	02.18.068.00
17	On/Off Switch	---	02.19.016.00	02.19.016.00	02.19.006.00	02.19.006.00	02.19.006.00	02.19.006.00
18	Indicator Light, Red	---	02.19.154.00	02.19.154.00	02.19.151.00	02.19.151.00	---	---
	Indicator Light, Yellow	---	---	---	---	---	---	---
19	Indicator Light, Green	---	---	---	---	---	02.19.150.00	02.19.150.00
20	Rubber Boot, Toggle Switch	---	---	---	---	---	02.20.040.00	02.20.040.00
21	Strain Relief	---	02.20.206.00	02.20.212.00	02.20.206.00	02.20.206.00	02.20.212.00	02.20.212.00
22	Light Bulb (Qty. 3)	---	02.30.043.00	02.30.043.00	02.30.058.00	02.30.058.00	02.30.058.00	02.30.058.00
23	Pan Rail	---	04.22.030.00	04.22.030.00	04.22.030.00	04.22.030.00	04.22.030.00	04.22.030.00
24	Pan Divider (optional)	---	04.22.400.00	04.22.400.00	04.22.400.00	04.22.400.00	04.22.400.00	04.22.400.00
25	Water Trough	---	---	---	---	---	---	---
26	Pan Enclosure, 2 Pan (optional)	---	04.22.406.00	04.22.406.00	04.22.406.00	04.22.406.00	04.22.406.00	04.22.406.00
27	Pan Enclosure, 1 Pan*	---	---	---	---	---	---	---
28	End Glass (Qty. 2)	---	04.40.091.00	04.40.091.00	04.40.091.00	04.40.091.00	04.40.091.00	04.40.091.00
29	Curved Glass, Front	---	R04.40.095.00	R04.40.095.00	R04.40.095.00	R04.40.095.00	R04.40.095.00	R04.40.095.00
30	Rubber Foot, Pan Rail (Qty. 12)	---	05.06.039.00	05.06.039.00	05.06.039.00	05.06.039.00	05.06.039.00	05.06.039.00
31	Heating Element, Upper (Qty. 3)	---	R02.08.222.00	R02.08.222.00	R02.08.232.00	R02.08.232.00	R02.08.232.00	R02.08.265.00
32	Wire Guard (Qty. 3)	---	04.08.112.00	04.08.112.00	04.08.112.00	04.08.112.00	04.08.112.00	04.08.112.00
33	Infinite Control Switch (Qty. 2)	---	R02.19.018.00	R02.19.018.00	R02.19.019.00	R02.19.019.00	R02.19.019.00	R02.19.019.00
	Electrical Drawing	---	HS2-3314	HS2-3314	HS2-3420	HS2-3422	HS2-4167	HS2-4170

Shaded area reflects export models only.

* Not Shown

PARTS SPECIFIC TO MODEL GRCDH-2P								
ITEM	DESCRIPTION	100V	120V	120V CSA	220V	240V	220-230V CE	230-240V CE
8A	Glass Door, Inner	R00.01.0026.00	R00.01.0026.00	R00.01.0026.00	R00.01.0026.00	R00.01.0026.00	R00.01.0026.00	R00.01.0026.00
8B	Glass Door, Inner, Mirror	R00.01.0034.00	R00.01.0034.00	R00.01.0034.00	R00.01.0034.00	R00.01.0034.00	R00.01.0034.00	R00.01.0034.00
9A	Glass Door, Outer	R00.01.0025.00	R00.01.0025.00	R00.01.0025.00	R00.01.0025.00	R00.01.0025.00	R00.01.0025.00	R00.01.0025.00
9B	Glass Door, Outer, Mirror	R00.01.0033.00	R00.01.0033.00	R00.01.0033.00	R00.01.0033.00	R00.01.0033.00	R00.01.0033.00	R00.01.0033.00
10	Relay	02.01.088.00	02.01.088.00	02.01.088.00	02.01.180.00	02.01.105.00	02.01.180.00	02.01.105.00
11	Heating Element, Base (Qty. 2)	02.05.507.00	02.05.293.00	02.05.293.00	02.05.294.00	02.05.294.00	02.05.294.00	02.05.294.00
12	Heating Element, Water	02.05.508.00	02.05.295.00	02.05.295.00	02.05.296.00	02.05.296.00	02.05.296.00	02.05.296.00
13	Terminal Block, 3-Pole*	---	---	---	---	---	02.15.030.00	02.15.030.00
14	High Limit, Automatic	R02.16.036.00	R02.16.036.00	R02.16.036.00	R02.16.036.00	R02.16.036.00	R02.16.036.00	R02.16.036.00
15	High Limit, Manual*	02.16.071.00	02.16.071.00	02.16.071.00	02.16.071.00	02.16.071.00	02.16.071.00	02.16.071.00
16	Power Cord with Plug	R02.18.030.00	R02.18.030.00	R02.18.030.00	02.18.077.00	02.18.066.00	02.18.077.00	02.18.066.00
17	On/Off Switch	R02.19.016.00	02.19.016.00	02.19.016.00	02.19.008A.00	02.19.008A.00	02.19.008A.00	02.19.008A.00
18	Indicator Light, Red (Qty. 2)	02.19.154.00	02.19.154.00	02.19.154.00	02.19.151.00	02.19.151.00	---	---
	Indicator Light, Yellow	---	---	---	---	---	02.19.152.00	02.19.152.00
19	Indicator Light, Green	02.19.155.00	02.19.155.00	02.19.155.00	02.19.150.00	02.19.150.00	02.19.150.00	02.19.150.00
20	Rubber Boot, Toggle Switch	---	---	---	---	---	02.20.040.00	02.20.040.00
21	Strain Relief	02.20.206.00	02.20.206.00	02.20.206.00	02.20.212.00	02.20.212.00	02.20.212.00	02.20.212.00
22	Light Bulb (Qty. 3)	02.30.043.00	02.30.043.00	02.30.043.00	02.30.058.00	02.30.058.00	02.30.058.00	02.30.058.00
23	Pan Rail	---	---	---	---	---	---	---
24	Pan Divider (optional)	04.22.400.00	04.22.400.00	04.22.400.00	04.22.400.00	04.22.400.00	04.22.400.00	04.22.400.00
25	Water Trough	04.22.403.00	04.22.403.00	04.22.403.00	04.22.403.00	04.22.403.00	04.22.403.00	04.22.403.00
26	Pan Enclosure, 2 Pan (optional)	04.22.406.00	04.22.406.00	04.22.406.00	04.22.406.00	04.22.406.00	04.22.406.00	04.22.406.00
27	Pan Enclosure, 1 Pan*	---	---	---	---	---	---	---
28	End Glass (Qty. 2)	04.40.105.00	04.40.105.00	04.40.105.00	04.40.105.00	04.40.105.00	04.40.105.00	04.40.105.00
29	Curved Glass, Front	R04.40.106.00	R04.40.106.00	R04.40.106.00	R04.40.106.00	R04.40.106.00	R04.40.106.00	R04.40.106.00
30	Rubber Foot, Pan Rail	---	---	---	---	---	---	---
31	Heating Element, Upper	R02.08.560.00	R02.08.202.00	R02.08.202.00	R02.08.250.00	R02.08.251.00	R02.08.250.00	R02.08.251.00
32	Wire Guard	04.08.112.00	04.08.112.00	04.08.112.00	04.08.112.00	04.08.112.00	04.08.112.00	04.08.112.00
33	Infinite Control Switch (Qty. 2)	R02.19.160.00	R02.19.018.00	R02.19.018.00	R02.19.019.00	R02.19.019.00	R02.19.019.00	R02.19.019.00
	Electrical Drawing	HS2-5825	HS2-3544	HS2-3544	HS2-3546	HS2-3548	HS2-4163	HS2-4164

Shaded area reflects export models only.

* Not Shown

PARTS SPECIFIC TO MODEL GRCDH-2PD								
ITEM	DESCRIPTION	100V	120V	120V CSA	220V	240V	220-230V CE	230-240V CE
8A	Glass Door, Inner	---	R00.01.0030.00	R00.01.0030.00	R00.01.0030.00	R00.01.0030.00	R00.01.0030.00	R00.01.0030.00
8B	Glass Door, Inner, Mirror	---	R00.01.0038.00	R00.01.0038.00	R00.01.0038.00	R00.01.0038.00	R00.01.0038.00	R00.01.0038.00
9A	Glass Door, Outer	---	R00.01.0029.00	R00.01.0029.00	R00.01.0029.00	R00.01.0029.00	R00.01.0029.00	R00.01.0029.00
9B	Glass Door, Outer, Mirror	---	R00.01.0037.00	R00.01.0037.00	R00.01.0037.00	R00.01.0037.00	R00.01.0037.00	R00.01.0037.00
10	Relay	---	02.01.088.00	02.01.088.00	02.01.180.00	02.01.105.00	02.01.180.00	02.01.105.00
11	Heating Element, Base (Qty. 2)	---	02.05.293.00	02.05.293.00	02.05.294.00	02.05.294.00	02.05.294.00	02.05.294.00
12	Heating Element, Water	---	02.05.295.00	02.05.295.00	02.05.296.00	02.05.296.00	02.05.296.00	02.05.296.00
13	Terminal Block, 3-Pole*	---	---	---	---	---	02.15.030.00	02.15.030.00
14	High Limit, Automatic	---	R02.16.036.00	R02.16.036.00	R02.16.036.00	R02.16.036.00	R02.16.036.00	R02.16.036.00
15	High Limit, Manual*	---	02.16.071.00	02.16.071.00	02.16.071.00	02.16.071.00	02.16.071.00	02.16.071.00
16	Power Cord with Plug	---	R02.18.030.00	R02.18.083.00	02.18.077.00	02.18.068.00	02.18.077.00	02.18.068.00
17	On/Off Switch	---	02.19.016.00	02.19.016.00	02.19.006.00	02.19.006.00	02.19.006.00	02.19.006.00
18	Indicator Light, Red	---	02.19.154.00	02.19.154.00	02.19.151.00	02.19.151.00	---	---
	Indicator Light, Yellow	---	---	---	---	---	02.19.152.00	02.19.152.00
19	Indicator Light, Green	---	02.19.155.00	02.19.155.00	02.19.150.00	02.19.150.00	02.19.150.00	02.19.150.00
20	Rubber Boot, Toggle Switch	---	---	---	---	---	02.20.040.00	02.20.040.00
21	Strain Relief	---	02.20.206.00	02.20.212.00	02.20.212.00	02.20.212.00	02.20.212.00	02.20.212.00
22	Light Bulb (Qty. 6)	---	02.30.043.00	02.30.043.00	02.30.058.00	02.30.058.00	02.30.058.00	02.30.058.00
23	Pan Rail	---	---	---	---	---	---	---
24	Pan Divider (optional)	---	04.22.400.00	04.22.400.00	04.22.400.00	04.22.400.00	04.22.400.00	04.22.400.00
25	Water Trough	---	04.22.403.00	04.22.403.00	04.22.403.00	04.22.403.00	04.22.403.00	04.22.403.00
26	Pan Enclosure, 2 Pan (optional)	---	04.22.406.00	04.22.406.00	04.22.406.00	04.22.406.00	04.22.406.00	04.22.406.00
27	Pan Enclosure, 1 Pan*	---	---	---	---	---	---	---
28	End Glass (Qty. 2)	---	04.40.091.00	04.40.091.00	04.40.091.00	04.40.091.00	04.40.091.00	04.40.091.00
29	Curved Glass, Front	---	R04.40.095.00	R04.40.095.00	R04.40.095.00	R04.40.095.00	R04.40.095.00	R04.40.095.00
30	Rubber Foot, Pan Rail (Qty. 12)	---	---	---	---	---	---	---
31	Heating Element, Upper (Qty. 3)	---	R02.08.222.00	R02.08.222.00	R02.08.232.00	R02.08.232.00	R02.08.232.00	R02.08.232.00
32	Wire Guard (Qty. 3)	---	04.08.112.00	04.08.112.00	04.08.112.00	04.08.112.00	04.08.112.00	04.08.112.00
33	Infinite Control Switch (Qty. 3)	---	R02.19.018.00	R02.19.018.00	R02.19.019.00	R02.19.019.00	R02.19.019.00	R02.19.019.00
	Electrical Drawing	---	HS2-3313	HS2-3313	HS2-3419	HS2-3421	HS2-4171	HS2-4172

Shaded area reflects export models only.

* Not Shown

PARTS SPECIFIC TO MODEL GRCD-3P								
ITEM	DESCRIPTION	100V	120V	120V CSA	220V	240V	220-230V CE	230-240V CE
8A	Glass Door, Inner	---	R00.01.0028.00	R00.01.0028.00	R00.01.0028.00	R00.01.0028.00	R00.01.0028.00	R00.01.0028.00
8B	Glass Door, Inner, Mirror	---	R00.01.0036.00	R00.01.0036.00	R00.01.0036.00	R00.01.0036.00	R00.01.0036.00	R00.01.0036.00
9A	Glass Door, Outer	---	R00.01.0027.00	R00.01.0027.00	R00.01.0027.00	R00.01.0027.00	R00.01.0027.00	R00.01.0027.00
9B	Glass Door, Outer, Mirror	---	R00.01.0035.00	R00.01.0035.00	R00.01.0035.00	R00.01.0035.00	R00.01.0035.00	R00.01.0035.00
10	Relay	---	---	---	---	---	---	---
11	Heating Element, Base (Qty. 3)	---	02.05.293.00	02.05.293.00	02.05.294.00	02.05.294.00	02.05.294.00	02.05.294.00
12	Heating Element, Water	---	---	---	---	---	---	---
13	Terminal Block, 3-Pole*	---	---	---	---	---	02.15.030.00	02.15.030.00
14	High Limit, Automatic	---	---	---	---	---	---	---
15	High Limit, Manual*	---	---	---	---	---	---	---
16	Power Cord with Plug	---	R02.18.030.00	R02.18.030.00	02.18.077.00	02.18.066.00	02.18.077.00	02.18.068.00
17	On/Off Switch	---	02.19.016.00	02.19.016.00	02.19.006.00	02.19.006.00	02.19.008A.00	02.19.008A.00
18	Indicator Light, Red	---	02.19.154.00	02.19.154.00	02.19.151.00	02.19.151.00	---	---
	Indicator Light, Yellow	---	---	---	---	---	---	---
19	Indicator Light, Green	---	---	---	---	---	02.19.150.00	02.19.150.00
20	Rubber Boot, Toggle Switch	---	---	---	---	---	02.20.040.00	02.20.040.00
21	Strain Relief	---	02.20.206.00	02.20.206.00	02.20.212.00	02.20.212.00	02.20.212.00	02.20.212.00
22	Light Bulb (Qty. 3)	---	02.30.043.00	02.30.043.00	02.30.058.00	02.30.058.00	02.30.058.00	02.30.058.00
23	Pan Rail	---	04.22.031.00	04.22.031.00	04.22.031.00	04.22.031.00	04.22.031.00	04.22.031.00
24	Pan Divider (optional)	---	04.22.400.00	04.22.400.00	04.22.400.00	04.22.400.00	04.22.400.00	04.22.400.00
25	Water Trough	---	---	---	---	---	---	---
26	Pan Enclosure, 2 Pan (optional)	---	04.22.406.00	04.22.406.00	04.22.406.00	04.22.406.00	04.22.406.00	04.22.406.00
27	Pan Enclosure, 1 Pan*	---	04.22.407.00	04.22.407.00	04.22.407.00	04.22.407.00	04.22.407.00	04.22.407.00
28	End Glass (Qty. 2)	---	04.40.105.00	04.40.105.00	04.40.105.00	04.40.105.00	04.40.105.00	04.40.105.00
29	Curved Glass, Front	---	R04.40.107.00	R04.40.107.00	R04.40.107.00	R04.40.107.00	R04.40.107.00	R04.40.107.00
30	Rubber Foot, Pan Rail (Qty. 16)	---	05.06.039.00	05.06.039.00	05.06.039.00	05.06.039.00	05.06.039.00	05.06.039.00
31	Heating Element, Upper	---	R02.08.216.00	R02.08.216.00	R02.08.253.00	R02.08.254.00	R02.08.253.00	R02.08.254.00
32	Wire Guard	---	04.08.102.00	04.08.102.00	04.08.102.00	04.08.102.00	04.08.102.00	04.08.102.00
33	Infinite Control Switch	---	R02.19.018.00	R02.19.018.00	R02.19.019.00	R02.19.019.00	R02.19.019.00	R02.19.019.00
	Electrical Drawing	---	HS2-3539	HS2-3539	HS2-3541	HS2-3543	HS2-4161	HS2-4162

Shaded area reflects export models only.

* Not Shown

PARTS SPECIFIC TO MODEL GRCD-3PD								
ITEM	DESCRIPTION	100V	120V	120V CSA	220V	240V	220-230V CE	230-240V CE
8A	Glass Door, Inner	---	R00.01.0032.00	R00.01.0032.00	R00.01.0032.00	R00.01.0032.00	R00.01.0032.00	R00.01.0032.00
8B	Glass Door, Inner, Mirror	---	R00.01.0039.00	R00.01.0039.00	R00.01.0039.00	R00.01.0039.00	R00.01.0039.00	R00.01.0039.00
9A	Glass Door, Outer	---	R00.01.0031.00	R00.01.0031.00	R00.01.0031.00	R00.01.0031.00	R00.01.0031.00	R00.01.0031.00
9B	Glass Door, Outer, Mirror	---	R00.01.0040.00	R00.01.0040.00	R00.01.0040.00	R00.01.0040.00	R00.01.0040.00	R00.01.0040.00
10	Relay	---	---	---	---	---	---	---
11	Heating Element, Base (Qty. 2)	---	02.05.293.00	02.05.293.00	02.05.294.00	02.05.294.00	02.05.294.00	02.05.294.00
12	Heating Element, Water	---	---	---	---	---	---	---
13	Terminal Block, 3-Pole*	---	---	---	---	---	02.15.030.00	02.15.030.00
14	High Limit, Automatic	---	---	---	---	---	---	---
15	High Limit, Manual*	---	---	---	---	---	---	---
16	Power Cord with Plug	---	R02.18.030.00	R02.18.083.00	02.18.077.00	02.18.068.00	02.18.077.00	02.18.068.00
17	On/Off Switch	---	02.19.016.00	02.19.016.00	02.19.006.00	02.19.006.00	02.19.006.00	02.19.006.00
18	Indicator Light, Red	---	02.19.154.00	02.19.154.00	02.19.151.00	02.19.151.00	---	---
	Indicator Light, Yellow	---	---	---	---	---	---	---
19	Indicator Light, Green	---	---	---	---	---	02.19.150.00	02.19.150.00
20	Rubber Boot, Toggle Switch	---	---	---	---	---	02.20.040.00	02.20.040.00
21	Strain Relief	---	02.20.206.00	02.20.212.00	02.20.212.00	02.20.212.00	02.20.212.00	02.20.212.00
22	Light Bulb (Qty. 6)	---	02.30.043.00	02.30.043.00	02.30.058.00	02.30.058.00	02.30.058.00	02.30.058.00
23	Pan Rail	---	04.22.031.00	04.22.031.00	04.22.031.00	04.22.031.00	04.22.031.00	04.22.031.00
24	Pan Divider (optional)	---	04.22.400.00	04.22.400.00	04.22.400.00	04.22.400.00	04.22.400.00	04.22.400.00
25	Water Trough	---	---	---	---	---	---	---
26	Pan Enclosure, 2 Pan (optional)	---	04.22.406.00	04.22.406.00	04.22.406.00	04.22.406.00	04.22.406.00	04.22.406.00
27	Pan Enclosure, 1 Pan*	---	04.22.407.00	04.22.407.00	04.22.407.00	04.22.407.00	04.22.407.00	04.22.407.00
28	End Glass	---	04.40.091.00	04.40.091.00	04.40.091.00	04.40.091.00	04.40.091.00	04.40.091.00
29	Curved Glass, Front	---	R04.40.096.00	R04.40.096.00	R04.40.096.00	R04.40.096.00	R04.40.096.00	R04.40.096.00
30	Rubber Foot, Pan Rail (Qty. 16)	---	05.06.039.00	05.06.039.00	05.06.039.00	05.06.039.00	05.06.039.00	05.06.039.00
31	Heating Element, Upper (Qty. 3)	---	R02.08.217.00	R02.08.217.00	R02.08.265.00	R02.08.265.00	R02.08.265.00	R02.08.265.00
32	Wire Guard (Qty. 3)	---	04.08.131.00	04.08.131.00	04.08.131.00	04.08.131.00	04.08.131.00	04.08.131.00
33	Infinite Control Switch (Qty. 2)	---	R02.19.018.00	R02.19.018.00	R02.19.019.00	R02.19.019.00	R02.19.019.00	R02.19.019.00
	Electrical Drawing	---	HS2-3312	HS2-3312	HS2-3423	HS2-3425	HS2-4169	HS2-4170

Shaded area reflects export models only.

* Not Shown

PARTS SPECIFIC TO MODEL GRCDH-3P								
ITEM	DESCRIPTION	100V	120V	120V CSA	220V	240V	220-230V CE	230-240V CE
8A	Glass Door, Inner	R00.01.0028.00	R00.01.0028.00	R00.01.0028.00	R00.01.0028.00	R00.01.0028.00	R00.01.0028.00	R00.01.0028.00
8B	Glass Door, Inner, Mirror	R00.01.0036.00	R00.01.0036.00	R00.01.0036.00	R00.01.0036.00	R00.01.0036.00	R00.01.0036.00	R00.01.0036.00
9A	Glass Door, Outer	R00.01.0027.00	R00.01.0027.00	R00.01.0027.00	R00.01.0027.00	R00.01.0027.00	R00.01.0027.00	R00.01.0027.00
9B	Glass Door, Outer, Mirror	R00.01.0035.00	R00.01.0035.00	R00.01.0035.00	R00.01.0035.00	R00.01.0035.00	R00.01.0035.00	R00.01.0035.00
10	Relay	02.01.088.00	02.01.088.00	02.01.088.00	02.01.180.00	02.01.105.00	02.01.180.00	02.01.105.00
11	Heating Element, Base (Qty. 3)	02.05.507.00	02.05.293.00	02.05.293.00	02.05.294.00	02.05.294.00	02.05.294.00	02.05.294.00
12	Heating Element, Water	02.05.508.00	02.05.295.00	02.05.295.00	02.05.296.00	02.05.296.00	02.05.296.00	02.05.296.00
13	Terminal Block, 3-Pole*	---	---	---	---	---	02.15.030.00	02.15.030.00
14	High Limit, Automatic	R02.16.036.00	R02.16.036.00	R02.16.036.00	R02.16.036.00	R02.16.036.00	R02.16.036.00	R02.16.036.00
15	High Limit, Manual*	02.16.071.00	02.16.071.00	02.16.071.00	02.16.071.00	02.16.071.00	02.16.071.00	02.16.071.00
16	Power Cord with Plug	R02.18.030.00	R02.18.030.00	R02.18.030.00	02.18.077.00	02.18.066.00	02.18.077.00	02.18.066.00
17	On/Off Switch	R02.19.016.00	02.19.016.00	02.19.016.00	02.19.008A.00	02.19.008A.00	02.19.008A.00	02.19.008A.00
18	Indicator Light, Red (Qty. 2)	02.19.154.00	02.19.154.00	02.19.154.00	02.19.151.00	02.19.151.00	---	---
	Indicator Light, Yellow	---	---	---	---	---	02.19.152.00	02.19.152.00
19	Indicator Light, Green	02.19.155.00	02.19.155.00	02.19.155.00	02.19.150.00	02.19.150.00	02.19.150.00	02.19.150.00
20	Rubber Boot, Toggle Switch	---	---	---	---	---	02.20.040.00	02.20.040.00
21	Strain Relief	02.20.206.00	02.20.206.00	02.20.206.00	02.20.212.00	02.20.212.00	02.20.212.00	02.20.212.00
22	Light Bulb (Qty. 3)	02.30.043.00	02.30.043.00	02.30.043.00	02.30.058.00	02.30.058.00	02.30.058.00	02.30.058.00
23	Pan Rail	---	---	---	---	---	---	---
24	Pan Divider (optional)	04.22.400.00	04.22.400.00	04.22.400.00	04.22.400.00	04.22.400.00	04.22.400.00	04.22.400.00
25	Water Trough	04.22.403.00	04.22.403.00	04.22.403.00	04.22.403.00	04.22.403.00	04.22.403.00	04.22.403.00
26	Pan Enclosure, 2 Pan (optional)	04.22.406.00	04.22.406.00	04.22.406.00	04.22.406.00	04.22.406.00	04.22.406.00	04.22.406.00
27	Pan Enclosure, 1 Pan*	04.22.407.00	04.22.407.00	04.22.407.00	04.22.407.00	04.22.407.00	04.22.407.00	04.22.407.00
28	End Glass (Qty. 2)	04.40.105.00	04.40.105.00	04.40.105.00	04.40.105.00	04.40.105.00	04.40.105.00	04.40.105.00
29	Curved Glass, Front	R04.40.107.00	R04.40.107.00	R04.40.107.00	R04.40.107.00	R04.40.107.00	R04.40.107.00	R04.40.107.00
30	Rubber Foot, Pan Rail	---	---	---	---	---	---	---
31	Heating Element, Upper	R02.08.567.00	R02.08.216.00	R02.08.216.00	R02.08.253.00	R02.08.254.00	R02.08.253.00	R02.08.254.00
32	Wire Guard	04.08.102.00	04.08.102.00	04.08.102.00	04.08.102.00	04.08.102.00	04.08.102.00	04.08.102.00
33	Infinite Control Switch (Qty. 2)	R02.19.160.00	R02.19.018.00	R02.19.018.00	R02.19.019.00	R02.19.019.00	R02.19.019.00	R02.19.019.00
	Electrical Drawing	HS2-5850	HS2-3545	HS2-3545	HS2-3547	HS2-3549	HS2-4165	HS2-4166

Shaded area reflects export models only.

* Not Shown

PARTS SPECIFIC TO MODEL GRCDH-3PD								
ITEM	DESCRIPTION	100V	120V	120V CSA	220V	240V	220-230V CE	230-240V CE
8A	Glass Door, Inner	---	R00.01.0032.00	R00.01.0032.00	R00.01.0032.00	R00.01.0032.00	R00.01.0032.00	R00.01.0032.00
8B	Glass Door, Inner, Mirror	---	R00.01.0039.00	R00.01.0039.00	R00.01.0039.00	R00.01.0039.00	R00.01.0039.00	R00.01.0039.00
9A	Glass Door, Outer	---	R00.01.0031.00	R00.01.0031.00	R00.01.0031.00	R00.01.0031.00	R00.01.0031.00	R00.01.0031.00
9B	Glass Door, Outer, Mirror	---	R00.01.0040.00	R00.01.0040.00	R00.01.0040.00	R00.01.0040.00	R00.01.0040.00	R00.01.0040.00
10	Relay	---	02.01.088.00	02.01.088.00	02.01.180.00	02.01.105.00	02.01.180.00	02.01.105.00
11	Heating Element, Base (Qty. 3)	---	02.05.293.00	02.05.293.00	02.05.294.00	02.05.294.00	02.05.294.00	02.05.294.00
12	Heating Element, Water	---	02.05.295.00	02.05.295.00	02.05.296.00	02.05.296.00	02.05.296.00	02.05.296.00
13	Terminal Block, 3-Pole*	---	---	---	---	---	02.15.030.00	02.15.030.00
14	High Limit, Automatic	---	R02.16.036.00	R02.16.036.00	R02.16.036.00	R02.16.036.00	R02.16.036.00	R02.16.036.00
15	High Limit, Manual*	---	02.16.071.00	02.16.071.00	02.16.071.00	02.16.071.00	02.16.071.00	02.16.071.00
16	Power Cord with Plug	---	R02.18.083.00	R02.18.039.00	02.18.077.00	02.18.068.00	02.18.077.00	02.18.068.00
17	On/Off Switch	---	02.19.016.00	02.19.016.00	02.19.006.00	02.19.006.00	02.19.006.00	02.19.006.00
18	Indicator Light, Red	---	02.19.154.00	02.19.154.00	02.19.151.00	02.19.151.00	---	---
	Indicator Light, Yellow	---	---	---	---	---	02.19.152.00	02.19.152.00
19	Indicator Light, Green	---	02.19.155.00	02.19.155.00	02.19.150.00	02.19.150.00	02.19.150.00	02.19.150.00
20	Rubber Boot, Toggle Switch	---	---	---	---	---	02.20.040.00	02.20.040.00
21	Strain Relief	---	02.20.212.00	02.20.209.00	02.20.212.00	02.20.212.00	02.20.212.00	02.20.212.00
22	Light Bulb (Qty. 6)	---	02.30.043.00	02.30.043.00	02.30.058.00	02.30.058.00	02.30.058.00	02.30.058.00
23	Pan Rail	---	---	---	---	---	---	---
24	Pan Divider (optional)	---	04.22.400.00	04.22.400.00	04.22.400.00	04.22.400.00	04.22.400.00	04.22.400.00
25	Water Trough	---	04.22.403.00	04.22.403.00	04.22.403.00	04.22.403.00	04.22.403.00	04.22.403.00
26	Pan Enclosure, 2 Pan (optional)	---	04.22.406.00	04.22.406.00	04.22.406.00	04.22.406.00	04.22.406.00	04.22.406.00
27	Pan Enclosure, 1 Pan*	---	04.22.407.00	04.22.407.00	04.22.407.00	04.22.407.00	04.22.407.00	04.22.407.00
28	End Glass	---	04.40.091.00	04.40.091.00	04.40.091.00	04.40.091.00	04.40.091.00	04.40.091.00
29	Curved Glass, Front	---	R04.40.096.00	R04.40.096.00	R04.40.096.00	R04.40.096.00	R04.40.096.00	R04.40.096.00
30	Rubber Foot, Pan Rail (Qty. 16)	---	---	---	---	---	---	---
31	Heating Element, Upper (Qty. 3)	---	R02.08.217.00	R02.08.217.00	R02.08.265.00	R02.08.265.00	R02.08.265.00	R02.08.265.00
32	Wire Guard (Qty. 3)	---	04.08.131.00	04.08.131.00	04.08.131.00	04.08.131.00	04.08.131.00	04.08.131.00
33	Infinite Control Switch (Qty. 3)	---	R02.19.018.00	R02.19.018.00	R02.19.019.00	R02.19.019.00	R02.19.019.00	R02.19.019.00
	Electrical Drawing	---	HS2-3311	HS2-3311	HS2-3424	HS2-3426	HS2-4173	HS2-4174

Shaded area reflects export models only.

* Not Shown