

Hamilton Beach Commercial

October 2001 Rev. A

E915 Container

Fill Cap – 280079900

Cover – 280121200
(was 280079800)

32oz. Container Complete –
6126-91515



Hamilton Beach Commercial

October 2001 Rev. A

E915 Upper Housing Assembly

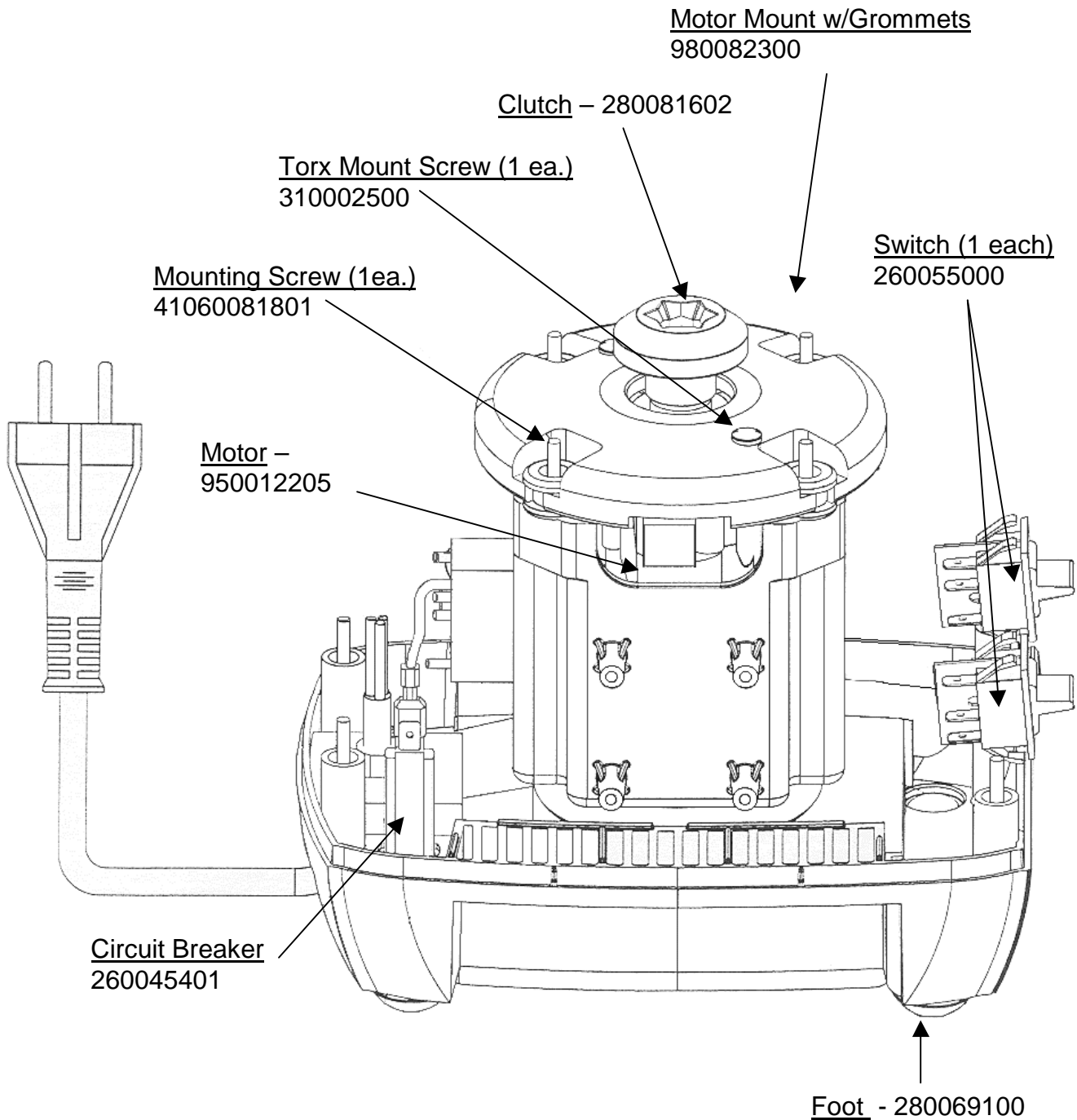

Hamilton Beach Commercial

October 2001 Rev. A

E915 Schematic

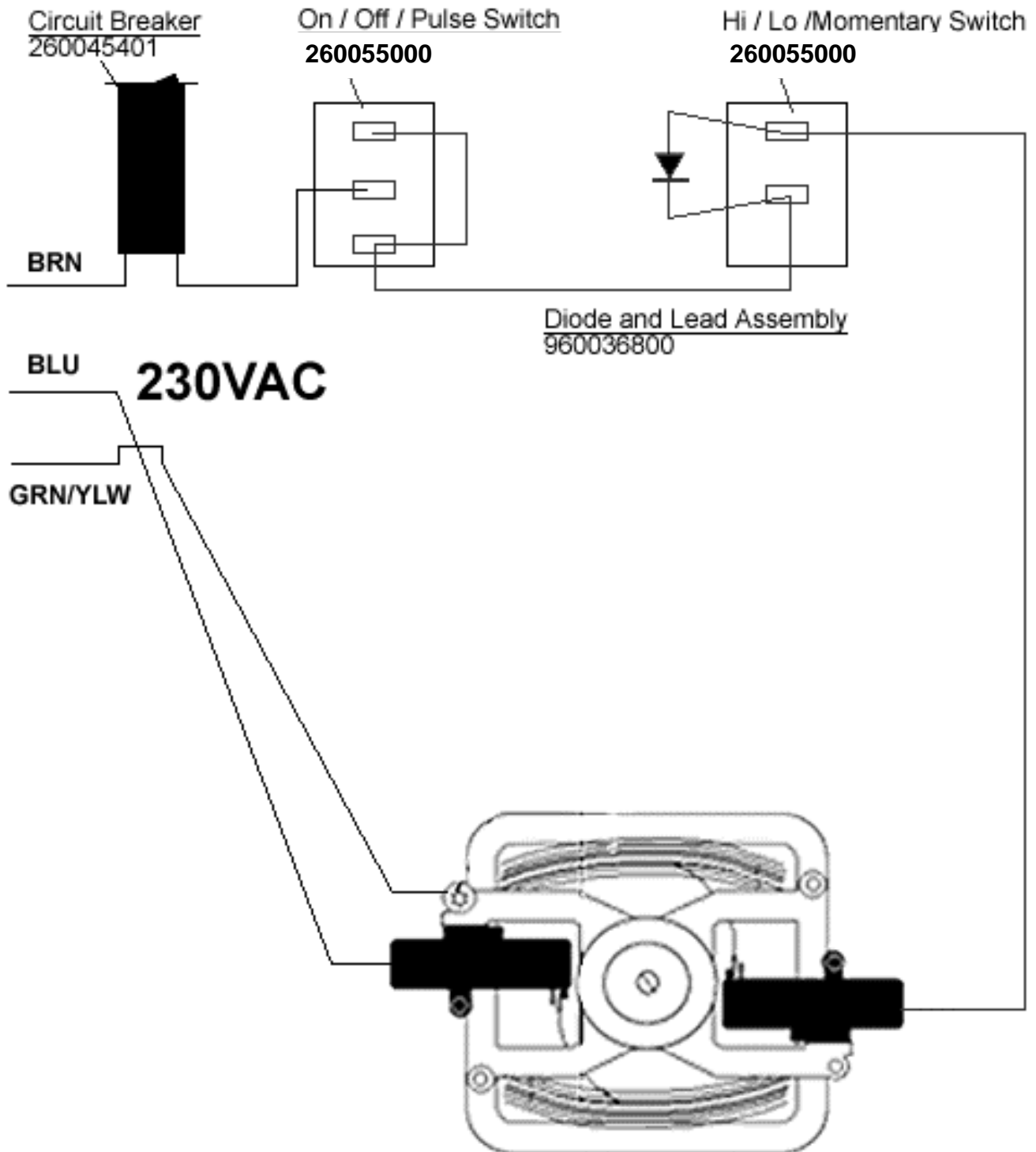

Hamilton Beach Commercial

October 2001 Rev. A

Disassembly of the E915 Blender

Remove the 4 Phillips screws from the bottom of the unit. Pull off the lower housing.

With the bottom housing removed, you probably have enough clearance to replace a bad switch (which you'll almost never see fail). If further disassembly is required for a motor or jar pad replacement, the coupling ("clutch") and 4 motor mount screws must be removed to pull the motor assembly out of the upper housing. Removal of an especially tight or seized coupling can be problematic. Definitely apply a lubricant and let stand for several hours.

The coupling is right-hand or standard thread; removal is counter-clockwise. Newer models feature a 1/8" Allen recess in the fan end of the shaft. The coupling recess is a 1/2" Allen hex. If you have the 1/8" Allen recess, use a ratchet bit instead of a wrench. If the coupling is extremely seized, a normal Allen wrench will twist or break.

Because exact placement of the fan is crucial to proper clearance, please do not attempt to remove or replace it. Order the motor complete (950012305).

Troubleshooting the 915 Blender

<u>Symptom</u>	<u>Possible Cause</u>	<u>Solution</u>
No Power Up	Circuit breaker opened	Reset / Test breaker
	Faulty power cord	Replace cord
	Open motor	Replace motor
Breaker Trips Repeatedly	Hi-resistance motor circuit (4.2 Ohms or higher as measured across the brush leads).	Replace motor.
	Defective breaker.	Replace breaker
Burning smell / Noise	Hi-resistance or open motor	Replace motor
	Broken / warped fan	Replace motor

If you have any questions, please call or mail me.

Chris Goodwin
Commercial Service Administrator
Hamilton Beach Commercial

christopher.goodwin@hamiltonbeach.com
+1 910 693 4277

Hamilton Beach Commercial

October 2001 Rev. A

Recommended Parts for Stock – E915

Part Number	Description	Stock Level
260045401	Circuit Breaker	Low
260055000	Switch (1 each)	Low
280081602	Clutch	High
280112903	Jar Pad	Low
32049110500	Foot (1 ea.)	Medium
6126-91515	Container Complete	Medium
950012205	Motor Complete	Medium
960036800	Speed Diode Assembly	Low